

# EXHIBITION MANUAL

23rd ESA Symposium on European Balloon and Rocket Programmes  
and related Research - 11-15 June 2017, Visby, Sweden

## VENUE

The venue of the exhibition, as well as the symposium, is Wisby Strand Conference Center.



Wisby Strand is located at the waterfront of Visby town, inside the old walls, next to the harbour and Almedalen park. The two recommended hotels of the symposium lies within 400 m from the venue.

## TRANSPORT AND FREIGHT

All items that are to be sent to the exhibition should be sent to the following address:

**WISBY STRAND CONGRESS & EVENT**  
**Strandvägen 4**  
**SE-621 55 Visby**  
**Sweden**

Please mark all items with: **ESA-PAC Symposium**

A HANDLING FEE WILL BE CHARGED FOR ITEMS SENT TO THE EXHIBITION.

– PALLET 1050 SEK

– PACKAGE 580 SEK

THE HANDLING FEE WILL BE INVOICED SEPARATELY TO THE EXHIBITOR AFTER CLOSURE OF EXHIBIT AND SHIPPING OF EVENTUAL RETURN ITEMS.

# EXHIBIT SPACE

Exhibition space at the symposium is located on the ground floor, adjacent to the main conference hall and in the area where the posters will be presented. This area will also be used for coffee breaks.

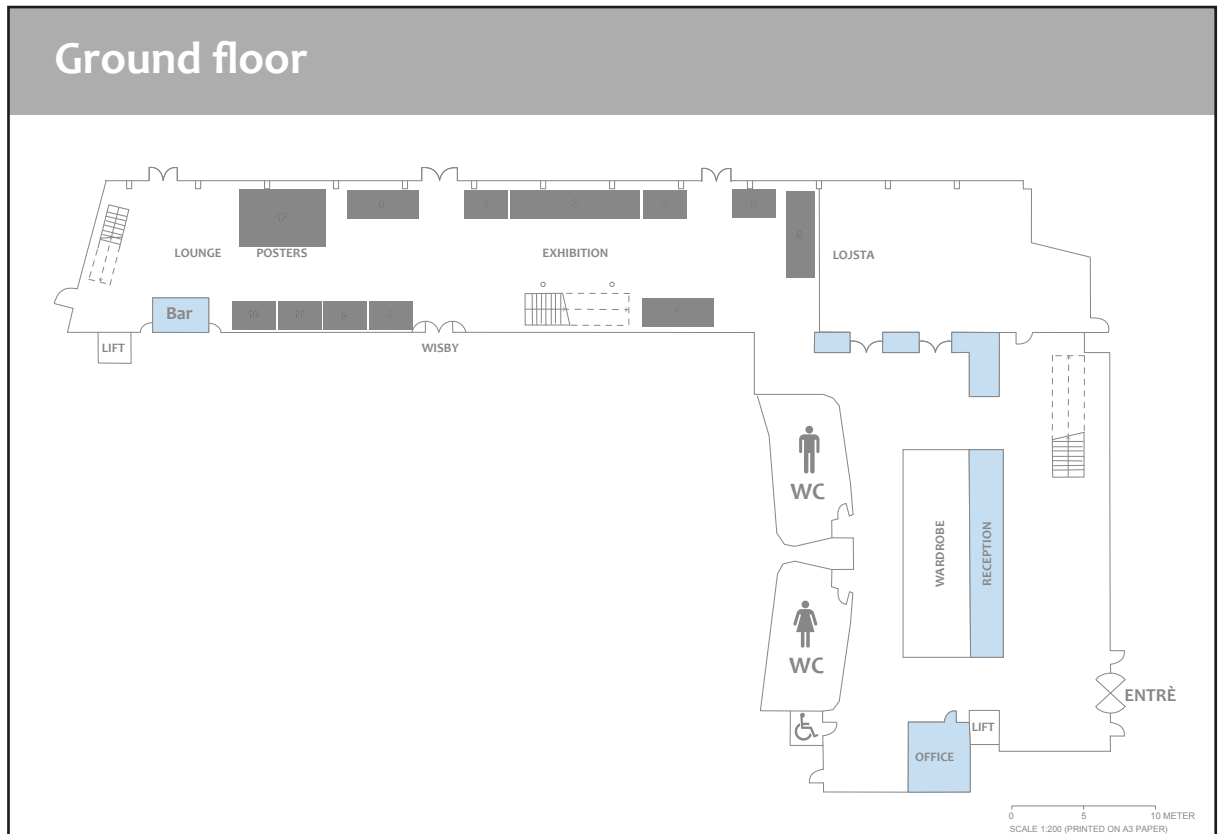

The image above shows a map of the exhibition area. The image below shows the rightmost part of the exhibition area, closest to the WC and conference room Lojsta.



The height to the ceiling is 2.7 m.

Please note that nothing can be suspended from the ceiling, or hung on the walls.

# FURNITURE

The following furniture can be ordered to the exhibition area:



TABLE

Size: 120 x 70 cm

TABLE

120 SEK



CHAIR

Size: 120 x 70 cm

CHAIR

76 SEK



HIGH TABLE

Size: Ø 60 cm

HIGH TABLE

236 SEK

No image

BAR STOOL

Suitable for High Table

BAR STOOL

112 SEK



POSTER WALL

Size: 168 x 89 cm

POSTER WALL 368 SEK

## CARPET

A grey carpet can be ordered on the floor space.

CARPET

128 SEK/SQUARE METER

FOR A STANDARD FLOORSPACE THIS AMOUNTS TO 768 SEK.

## INSTALLATION

The exhibition area can be accessed from 10.00 on Sunday June 11th.  
Note that registration and welcome drink will start at 16.00.

## WIFI

Complimentary WiFi connection will be available throughout the venue.

## NOTES ON PAYMENT

All prices are excluding VAT.

SSC will charge the exhibit space and carpet at booking.  
Additional furniture and other costs will be invoiced after the exhibit.